

Operator's Handbook

Ground Driven Spreader
MODEL AL350



ASK YOUR DEALER ABOUT THE FULL RAPIDSpray RANGE AND OUR 44 PAGE CATALOGUE

**CUSTOMER
SERVICE
FREECALL**

1800 816 277

FROM MOBILE PHONES PLEASE CALL 03 5866 3266



RSP008 C

Contents

Features.....	3
Introduction	4
Safety	4
Warranty.....	5
Hitching and towing your Spreader.....	5
Fertiliser spreading guide	6
Additional notes	7
Spread pattern selection.....	7
Maintenance.....	8
Exploded diagram AL 350	9
Parts List	10
Warranty.....	11
Warranty Registration Card.....	12



Features



1. 50mm tow hitch
2. Adjustable draw bar
3. High flotation wheels
4. Corrosion resistant poly hopper
5. Rigid poly hopper lid
6. Extendable control lever
7. Galvanised steel frame
8. Stainless steel agitator
9. Abrasion resistant poly spinner
10. Spring loaded adjustable spread fins
11. Spinner guard
12. Multiple position setting plate

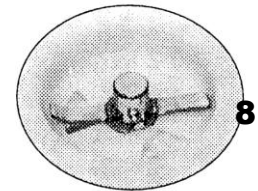

**READ YOUR OPERATOR'S HANDBOOK CAREFULLY
BEFORE MOUNTING AND USING YOUR SPRAYER.
KEEP YOUR HANDBOOK IN A SAFE PLACE.**

Introduction

Congratulations on your purchase of a high quality Activ8 AL350 Ground Driven Spreader which should give you years of trouble-free service by following the user guidelines as set out in this handbook. The AL350 has been specially designed to be towed behind an ATV quad bike, but has been fitted with an adjustable drawbar which allows the spreader to be towed behind vehicles with higher tow bars.

Safety

1. Read your ATV Owner's manual before mounting, towing or using any equipment on your ATV. **Comply with all weight restrictions as specified by the ATV manufacturer as overloading can cause injury or death.**
2. To ensure your own safety, comply with all relevant legislation and Codes of practice.
 - Pesticides Act 1978
 - Occupational Health and Safety Act 1983 (OHS Act)
 - Code of Practice for the safe use of chemicals (including Pesticides and Herbicides) in agriculture- Workcover Authority
3. Select and wear appropriate Personal Protection Equipment.
4. It is recommended that a speed of 15 kph is not exceeded while spreading

Hitching and Towing Your Spreader

1. Your Activ8 AL350 Spreader comes completely assembled except for the control lever which is supplied loose
2. Hitch the Spreader by withdrawing the spring loaded pin from the coupling handle while simultaneously lifting the handle. With the handle in the elevated position place the coupling over the tow ball of the ATV. Re-position the handle in the coupling body and ensure the spring loaded pin is re-engaged.
3. The hopper should be in a horizontal plane once hitched to the towing vehicle. Adjust the drawbar height by re-positioning the drawbar stay to obtain the correct hopper position.
4. Position the control lever so it can be operated from the driving seat.
5. Ensure tyre pressure for both the vehicle and the Spreader is set to the Manufacturer's specification as lateral stability may be reduced with over / under inflated tyres.

Fertiliser Spreading Guide

The flow rate from the hopper is determined by the aperture plate setting. There are 8 settings on the setting plate with 0 being the closed position and 8 being the fully opened position. Simply position the spring loaded calibration stop to your required setting.

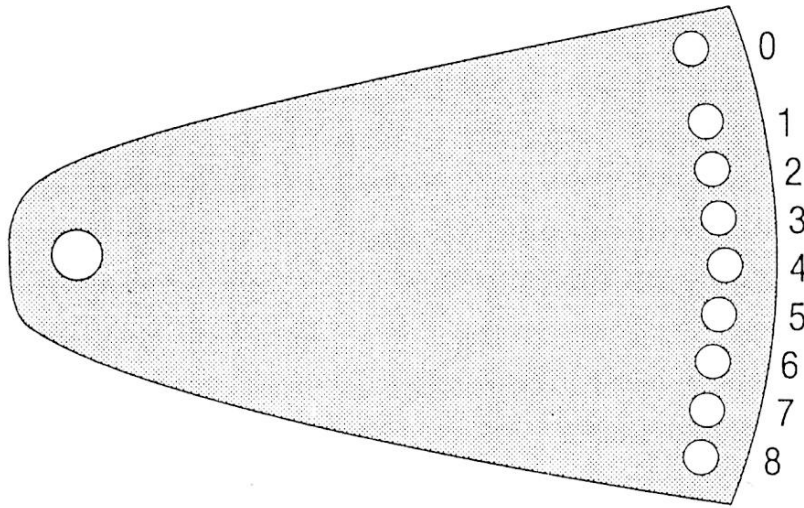

SUPER PHOSPHATE

Driving 15 metres apart per pass at 15km/h

Setting No	1	2	3	4	5	6	7	8
Kg/ha	25	55	95	135	185	245	305	325

UREA

Driving 15 metres apart per pass at 15 km/h

Setting No	2	3	4	5	6	7	8
Kg/ha	40	65	100	145	200	255	280

GRASS SEED

Driving 6 metres apart per pass at 15 km/h

Setting No	1	2	3
Kg/ha	7.5	28	45

These calibration settings are only as a guide due to variations in seed, fertiliser, humidity and temperature.

ADDITIONAL NOTES

1. Remove the drive pin from the axle while running free- this minimises wear and tear on the gearbox and hopper bush
2. Close the shutter plate while making turns at the ends of each application pass
3. Plan your application pattern to avoid over-application or missed areas
4. Take care when travelling sideways across the slope. If application has to be done on a steep slope travel up and down the slope.

SPREAD PATTERN SELECTION

The spinner plate incorporates three different spreader fin positions to select various spread options:



MAINTENANCE

A LUBRICATION

MAINTENANCE A LUBRICATION



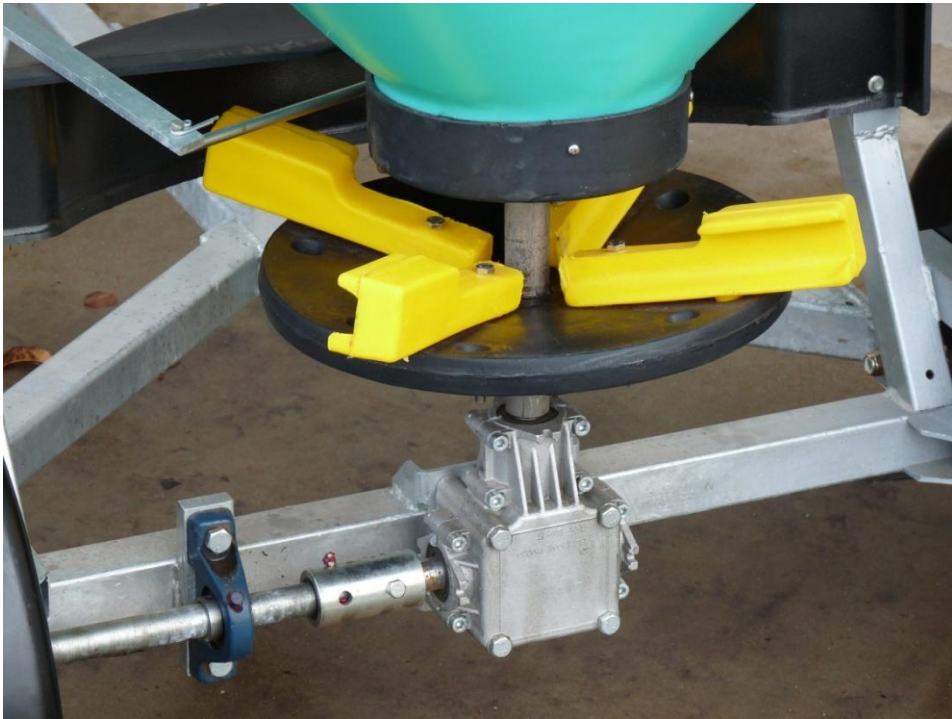

1. Grease left wheel bearing once a week
2. Ensure drive bush is well greased at all times
3. Apply lubrication oil spray to the agitator bush after each cleaning
4. Grease the setting plate so that the control lever moves freely

B CLEANING

1. Avoid leaving fertiliser in the hopper for any length of time
2. Cleaning your spreader thoroughly after each use will extend the life of your machine
3. Store machine when dry with hopper lid in position

C SPINNER DRIVE GEARBOX

1. The gearbox oil should be replaced after every 50 hours of use;
Remove plug from gearbox and drain
Turn spreader on its side
Fill with 350 ml SAE EP 90 oil and replace plug

Exploded View

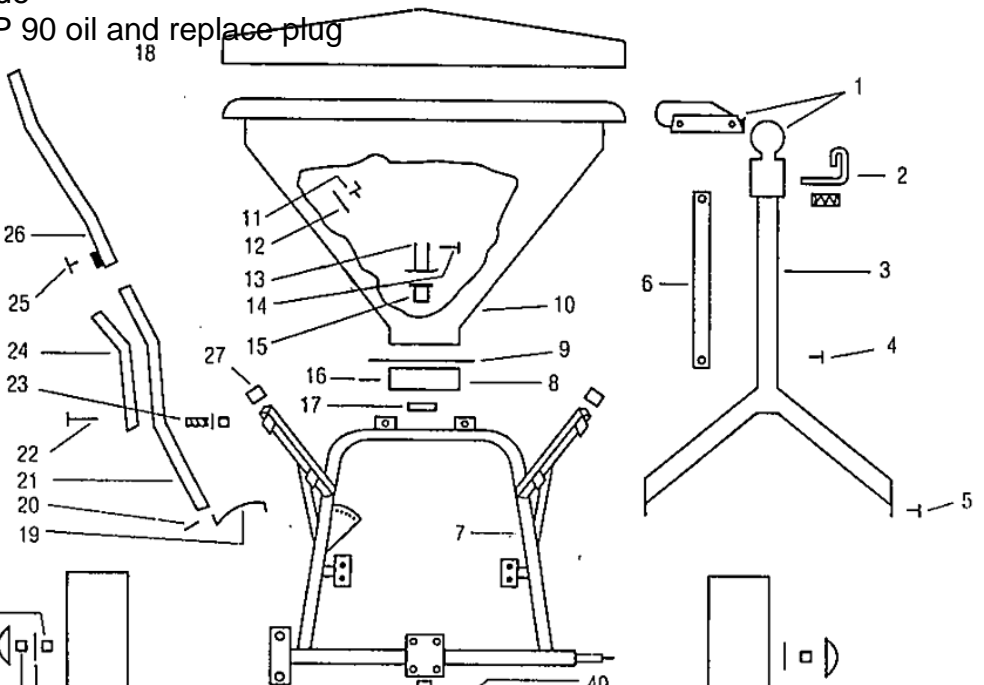

NO.	CODE	DESCRIPTION	QTY
1	ALS001	Tow ball handle	1
2	ALS002	Handle latch including split pin and spring	1
3	ALS003	Drawbar	1
4	ALS004	Drawbar stay bolt, nut and spring washer – galv.	2
5	ALS005	Drawbar bolt, nut and spring washer – galv.	2
6	ALS006	Drawbar stay	1
7	ALS007	Main frame	1
8	ALS008	Hopper cap	1
9	ALS009	Shutter plate	1
10	ALS010	Hopper 350 litre	1
11	ALS011	Hopper bolt, nut and spring washer – galv.	4
12	ALS012	Square galvanised M10 washer	4
13	ALS013	Stainless steel agitator	1
14	ALS014	Agitator bolt and nyloc nut s/s / Gearbox bush	2
15	ALS015	Hopper bush	1
16	ALS016	Hopper cap screws	3
17	ALS017	Hopper bush back nut	1
18	ALS018	Hopper lid	1
19	ALS019	Connector arm	1
20	ALS020	3mm Split pin and washer	2
21	ALS021	Shutter plate lever	1
22	ALS022	Control lever bolt, washer and nyloc nut	1
23	ALS023	Spring	1
24	ALS024	Calibration stop	1
25	ALS025	M8 Tee bolt	1
26	ALS026	Control handle	1
27	ALS027	RHS cap	2
28	ALS028	8mm Key	1
29	ALS029	Hub cap	2
30	ALS030	M16 Nyloc nut	2
31	ALS031	Washer	2
32	ALS032	Axle bearing	1
33	ALS033	Spinner guard	1
34	ALS034	Split pin	1
35	ALS035	Split pin	1
36	ALS036	Gearbox bush	1
37	ALS037	Gearbox	1
38	ALS038	Gearbox mount bolt nut and spring washer – galv.	4
39	ALS039	Spreader s/washer	1
40	ALS040	Spreader pin bolt, nyloc nut and washer	4
41	ALS041	Spring	1
42	ALS042	Spring	4
43	ALS043	Drive shaft	1
44	ALS044	Drivewheel	1

Warranty

Active Sprayers are warranted free from defect in workmanship or manufacture for 12 months from the date of purchase. Any parts which appear to us to be defective either in material or workmanship shall be replaced or repaired at no cost to the purchaser, subject to the following conditions:

1. The registration card in this handbook must be returned to us within 7 days of the purchase

2. In the unlikely event of equipment failure, this should be reported to your dealer who will act on your behalf to resolve the issue to your satisfaction.
3. Any defective parts will be returned by your dealer to us within 7 days of failure together with a report describing the failure and conditions in which the failure occurred
4. The following are specifically excluded from the terms of the warranty:
 - a) fair wear and tear to axle and spinner bushes
 - b) fair wear and tear to spinner fins
 - c) damage caused by neglect or lack of lubrication
 - d) damage caused by misuse or abuse
 - e) damage caused while the spreader is in transit
5. the warranty is for the benefit of the first user only



Manufactured by: Rapid Spray
Murray Valley Highway
Nathalia 3638
Australia
FREECALL 1800 816 277

Whilst every care has been taken in the preparation of these instructions, no liabilities can be accepted with regard to errors or omissions. Product specifications are subject to change in line with our commitment to continuous improvement.

WARRANTY REGISTRATION CARD

To validate your warranty, please complete all the details below and post this card.
I have read and understood these instructions.

Sprayer Model _____ Date purchased ____/____/____

Serial Number _____

Purchased from _____

(Dealer Name and Town)



Purchaser's Name _____

Purchaser's Address

_____ p/c _____

Purchaser's Signature _____

To help us help you further please complete the following –

Purchaser's Age

Up to 25

25 – 40

41-55

Over 55

Principle Usage

Commercial Farm

Hobby Farm

Industrial

Home

Town Council

Hire Company

Other

What influenced you to purchase a Rapid Spray product?

Catalogue received

Newspaper Advertisement

Dealer recommendation

Friend's recommendation

Better features than other sprayers

Quality and reliability

Price

Past experience with Rapid Spray products

What other Rapid Spray/Rapid Plas products do you use?

Animal Feeders/Waterers

RainWater Tanks

Spray Tanks

Diesel Tanks

Inter Knapsacks

Boom Sprayers

Bertolini Pumps and Controllers

Fire Fighters







Rapid Spray Southern
Murray Valley Hwy, Nathalia VIC 3638
PO Box 137, Nathalia VIC 3638
FREECALL: 1800 816 277
FAX: 03 5866 3019
www.rapidspray.com
warranty@rapidspray.com

